

BUFFET 1.60 MADRID
 BUFFTE 1.60 MADRID
 BUFFET 1.60 MADRID
 050.305

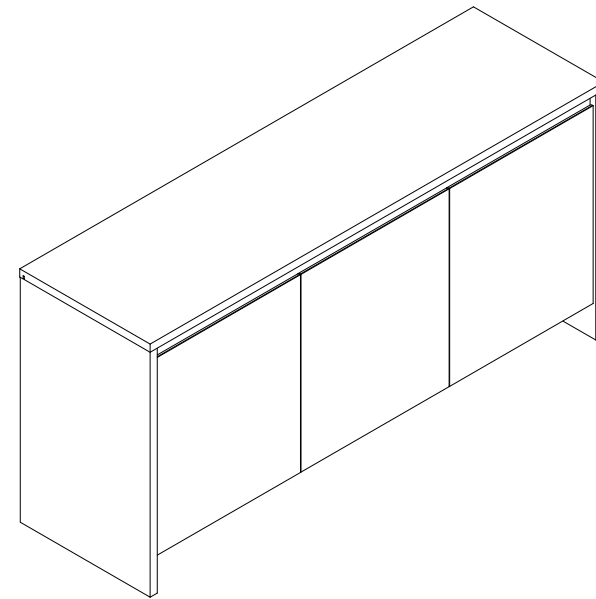

Procedimento para Solicitação de Assistência Técnica

Em caso de Assistência Técnica, entrar em contato com nosso Representante de Vendas, no [ato da montagem do produto](#) e informar o número do lote.

Procedimento para Solicitud de Asistencia Técnica

En caso de Asistencia Técnica, contactar a nuestro Representante de Ventas, en el [acto del montaje del producto](#) e informar el número de lote.

In case you need technical assistance, please contact our Sales Representative [at the time of assembly](#) and inform the lot number provided to the side.

Retirar todo o peso do móvel caso queira trocá-lo de local. Em alguns casos é recomendado desmontar o móvel, o que deve ser feito por um profissional qualificado.

Produto elaborado em madeira reconstituída MDF e/ou MDP e/ou BP. Acabamento fosco em verniz poliuretano ou poliéster. Fundos e contra-fundos em chapas de fibromadeira e/ou MDF. Ferragens e acessórios de aço zincado, zamack e/ou PVC. Bordos com fita de PVC, papel ou pintados. A empresa se reserva do direito de eventuar modificações de caráter técnico sem prévio aviso.

Sacar todo el peso del mueble en el caso de que desse cambiarlo de sitio. Em algunos casos, se recomienda que un profesional calificado desmonte el mueble.

Producto elaborado en madera reconstituída MDF y/o MDP y/o BP. Acabado opaco en barniz poliuretano o poliéster. Fondos y traseras en chapas de fibromadeira y/o MDF. Herrajes y accesorios de acero zincado, zamack y/o PVC. Bordas con cinta de PVC, papel o pintados. La empresa se reserva el derecho de efectuar cambios de carácter técnico sin previo aviso.

Take all of the weight off the furniture if you want to put it in a different place. In a few cases, it is recommended you disassemble the piece of furniture, and this should be done by a qualified professional.

Product made out of reconstituted wood MDF and/or MDP and/or BP. Finishing with shine and/or glaze with polyurethane or polyester varnish. Bottoms and rearends made out of wood fiber plates and/or MDF. Hardware and accessories made out of galvanized steel, zamack and/or PVC. Sides with PVC tape, paper or painted. The company reserves the right to make technical changes without prior notice.

LIMPEZA

PANO LEVEMENTE UMEDECIDO COM ÁGUA E SEGUIDO DE PANO SECO, NÃO UTILIZAR PRODUTOS QUÍMICOS OU ABRASIVOS.

LIMPIEZA

TRAPO LIGERAMENTE EMPAPADO EN AGUA SEGUIDO DE TRAPO SECO, NO UTILIZAR PRODUCTOS QUÍMICOS O ABRASIVOS.

WIPE WITH A SLIGHTLY DAMP CLOTH FOLLOWED BY A DRY CLOTH, DO NOT USE CHEMICAL OR ABRASIVE PRODUCTS.

DICAS / PISTAS / TIPS

- **Utilizar a própria embalagem como tapete, protegendo as peças durante a montagem;**
- **Observar o local exato da montagem para evitar movimentos desnecessários do móvel;**
- **Sugerir ao cliente que guarde este manual.**
- *Usar el propio embalaje como alfombra, protegiendo las piezas durante el montaje;*
- *Observar el lugar exacto del montaje para evitar movimientos innecesarios del mueble;*
- *Sugerir al cliente la guarda de este manual.*
- Use the package itself as rug to protect the parts during assembly;
- Observe the exact assembly location to avoid unnecessary movements of the furniture;
- Suggest the customer keep this manual.

Tenha em mãos: / Tenga en manos: / Have Readily Available



Partes do Produto

- 1** Tampo (1x) **7** Prateleira (3x) **13** Porta Esquerda (1x)
- 2** Lateral Esquerda (1x) **8** Frente de Gaveta (1x) **14** Porta Direita (1x)
- 3** Lateral Direita (1x) **9** Divisória Esquerda (1x) **15** Vista (1x)
- 4** Base(1x) **10** Divisória Direita (1x) **16** Fundo de Gaveta (1x)
- 5** Lateral de Gaveta (2x) **11** Rodapé de Apoio (1x) **17** Fundo (1x)
- 6** Traseiro de Gaveta (1x) **12** Porta Central (1x)

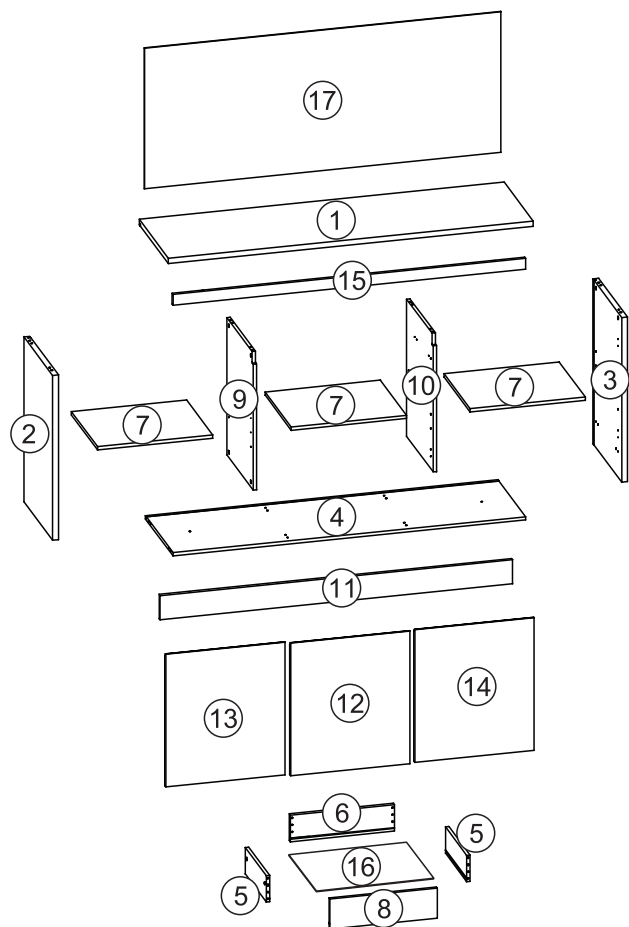

Componentes



A- Cavilha
Ø6x30 (25x)



B- Minifix
Ø6,3x11(22x)



C- Tambor
Ø15 (22x)



D- Parafuso
Ø5x50 (3x)



E- Parafuso
Ø4,5x16 (50x)



F- Parafuso
Ø4,5x20 (4x)



G- Conj. Corrediça
da Lateral
350mm (2x)



H- Corrediça
da Gaveta
350mm (2x)



I- Cola (1x)

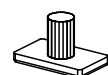

J- Sapata (6x)



K- Calço 3mm p/
Dobradiça (2x)



L- Calço 8mm p/
Dobradiça (4x)



M- Dobradiça (6x)



N- Suporte p/
Prateleira (12x)



O- Espaçador de
Corrediça (2x)



P- Cantoneira (2x)



Q- Tapa Furo
Adesivo Ø18 (16x)



R- Tapa Furo
Adesivo Ø12 (3x)



S- Fixador de
Fundos (10x)

Utilizar a régua abaixo para medir os componentes.

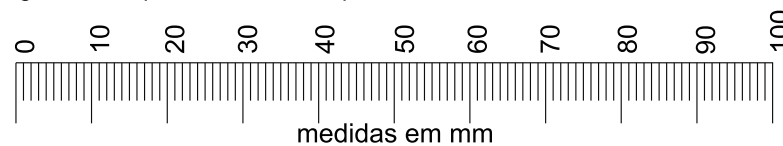

Pré-montagem

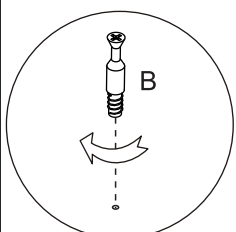
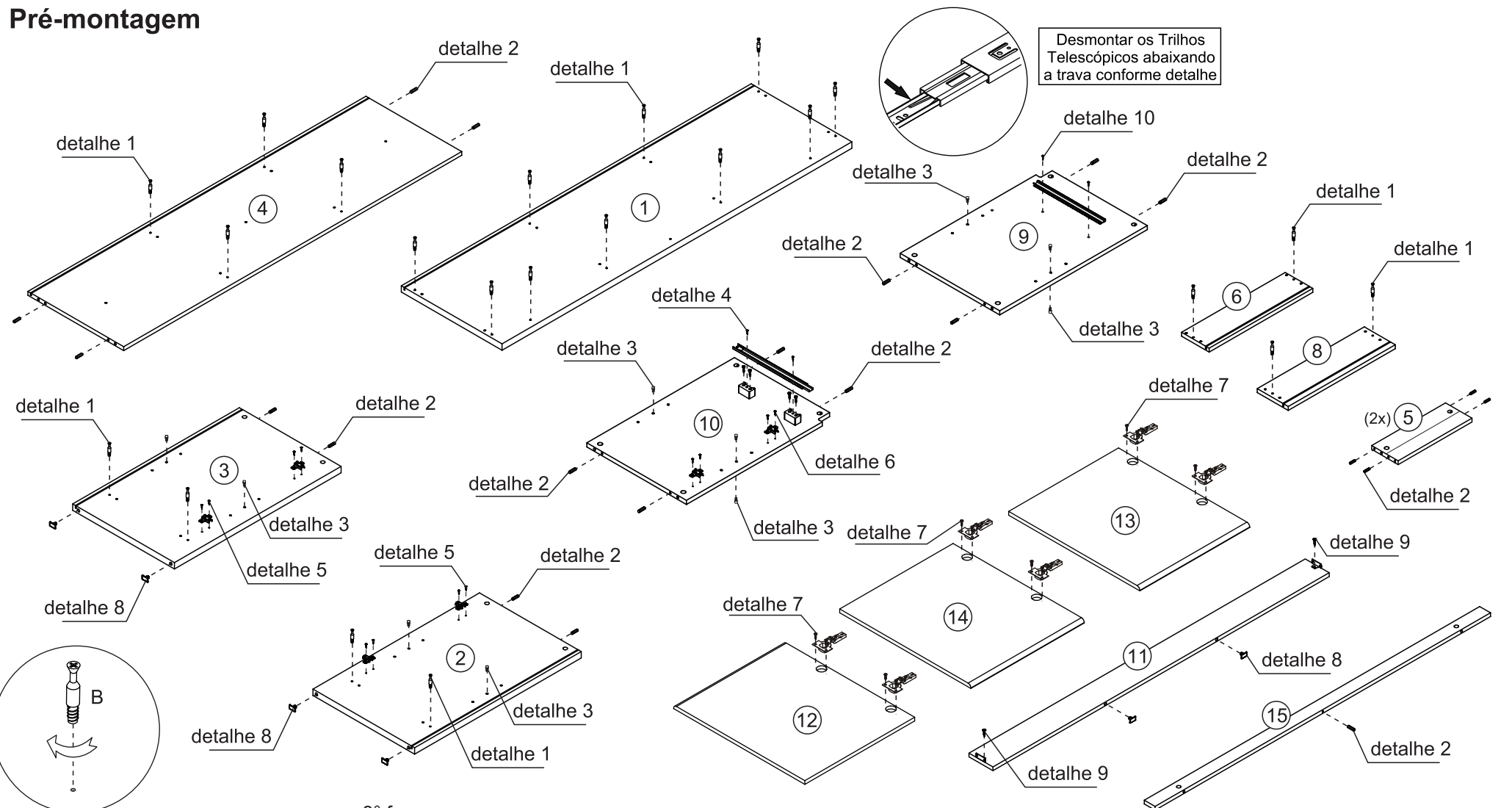

detalhe 1

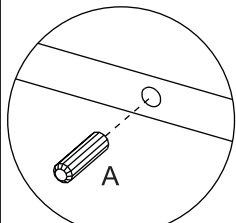

detalhe 2

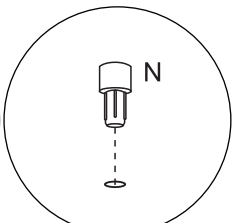

detalhe 3

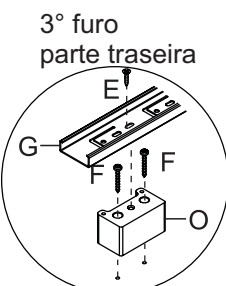

detalhe 4

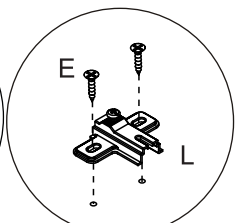

detalhe 5

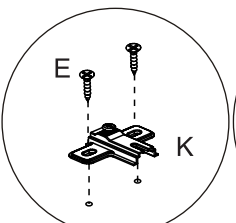

detalhe 6

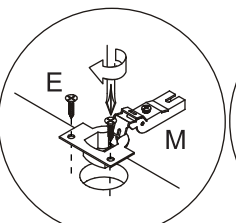

detalhe 7

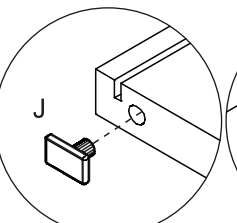

detalhe 8

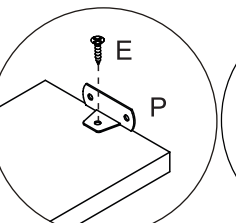

detalhe 9

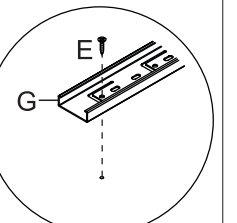

detalhe 10

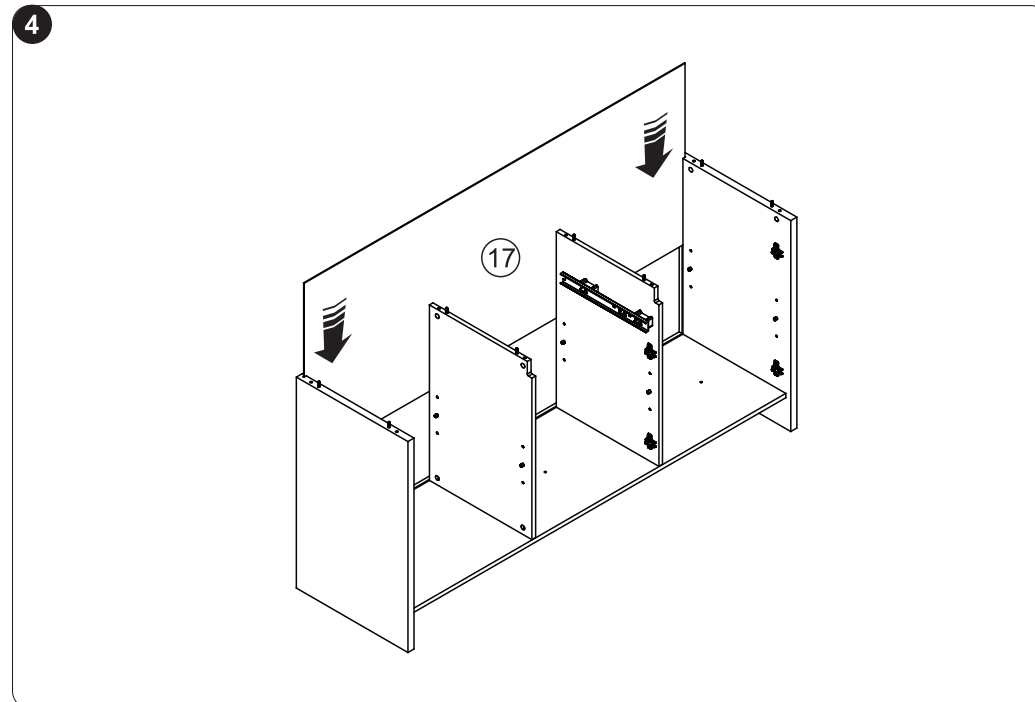
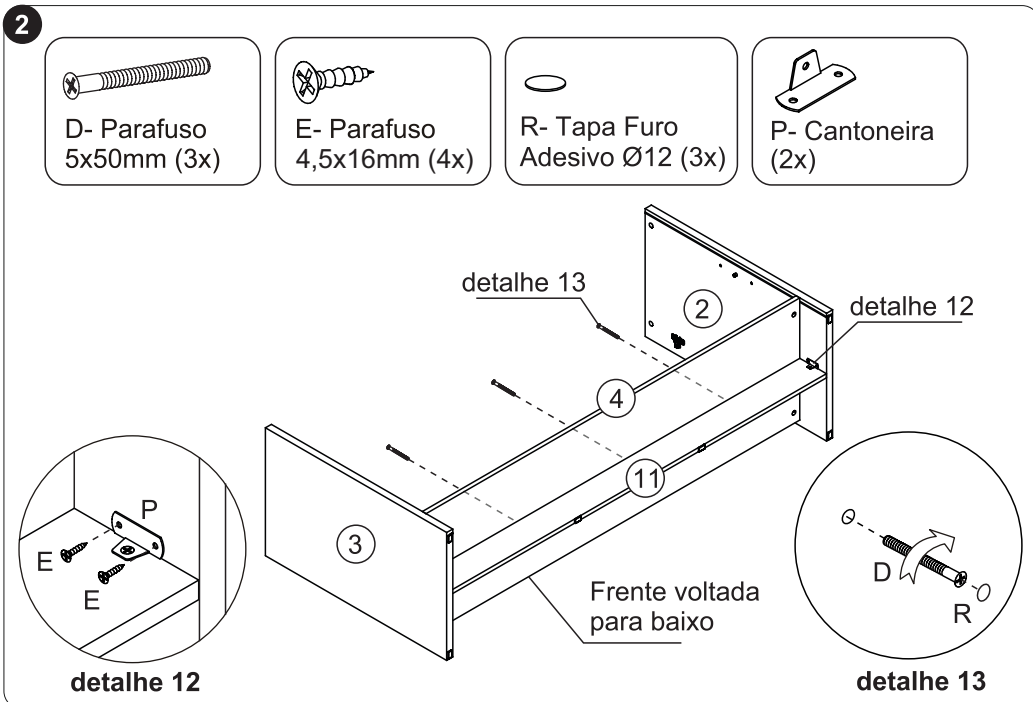
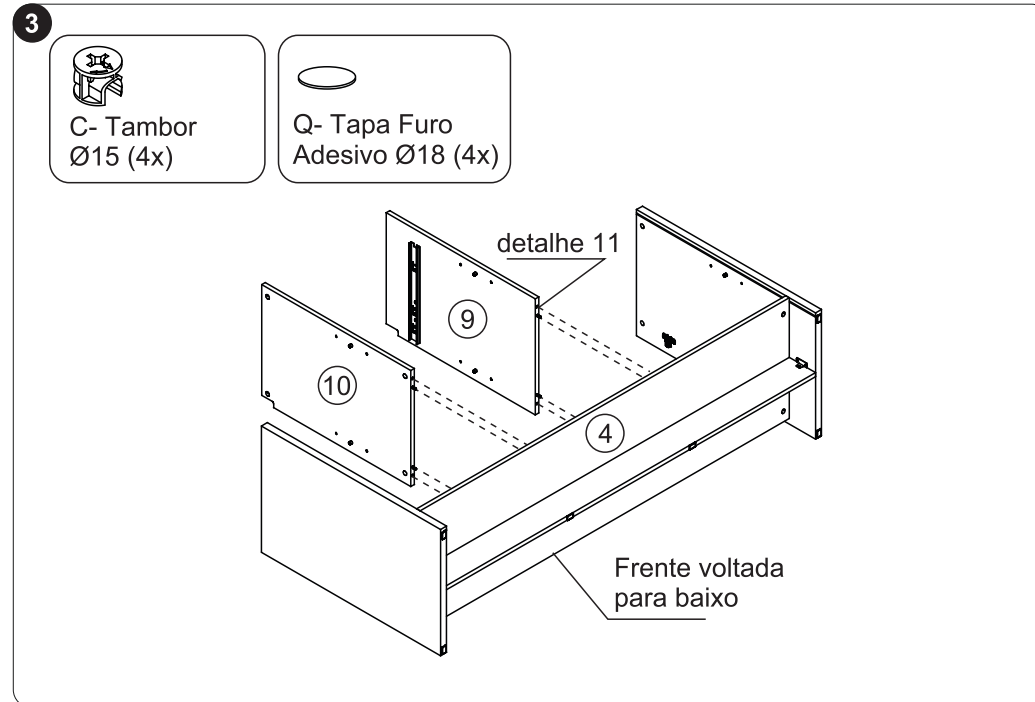
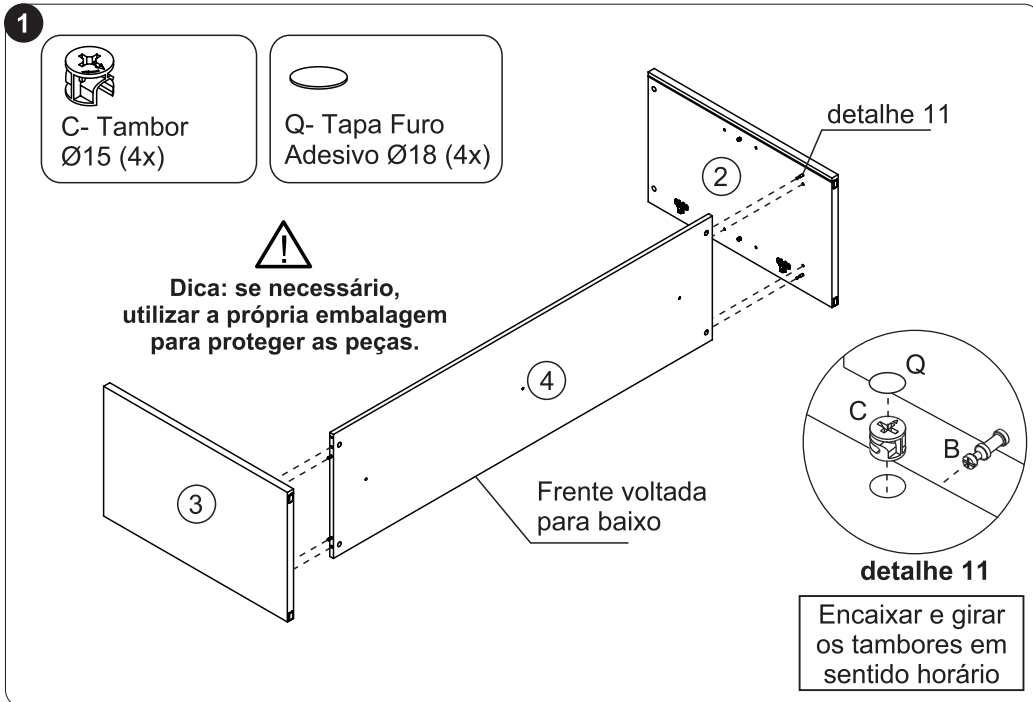

5

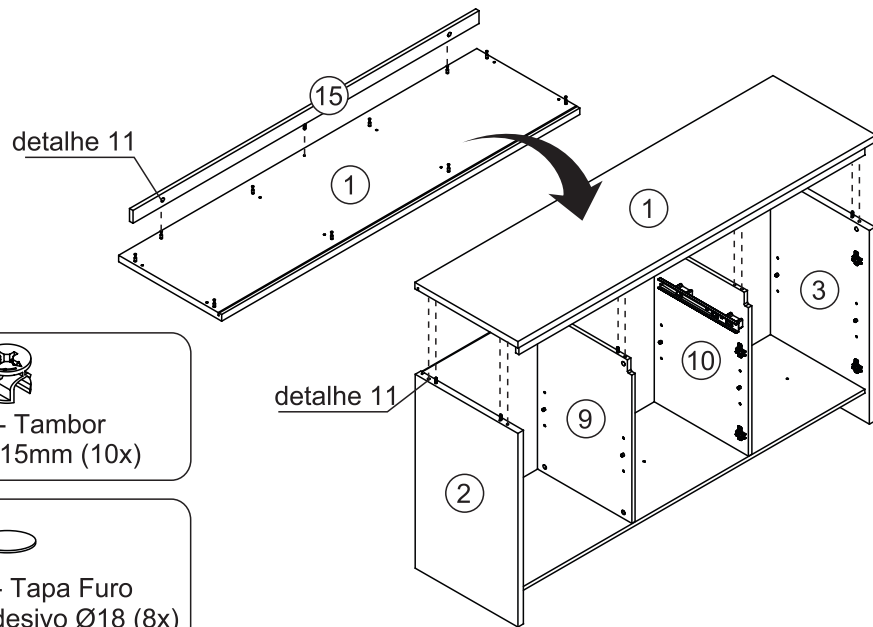

C- Tambor
Ø15mm (10x)



Q- Tapa Furo
Adesivo Ø18 (8x)

7



E- Parafuso
4,5x16mm (6x)



C- Tambor
Ø15mm (4x)



Q- Tapa Furo
Adesivo Ø18 (4x)



H- Corrediça da
Gaveta 350mm (2x)

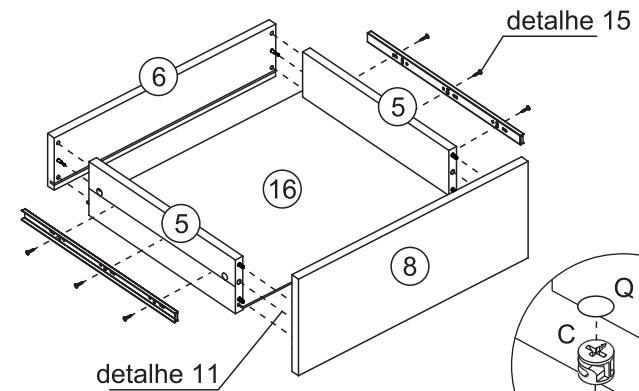

detalhe 11

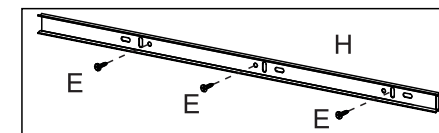

detalhe 15

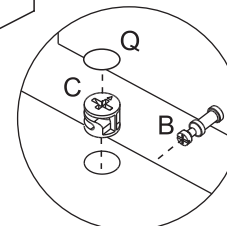

detalhe 11

Encaixar e girar
os tambores em
sentido horário

6



E- Parafuso
4,5x16mm (10x)



S- Fixador de
Fundos (10x)

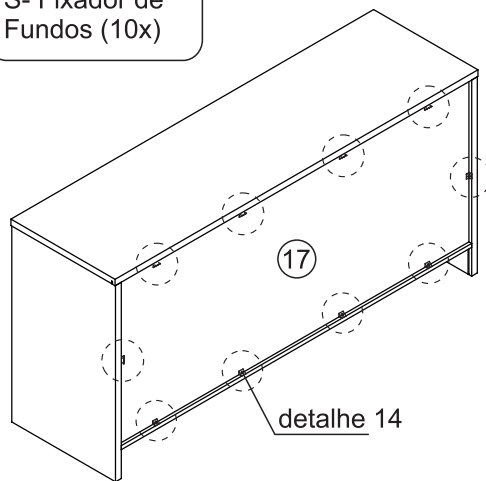

detalhe 14

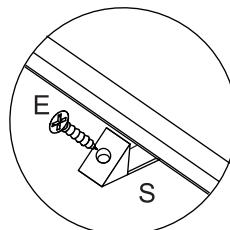

detalhe 14

8

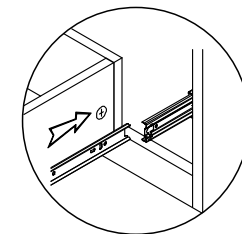
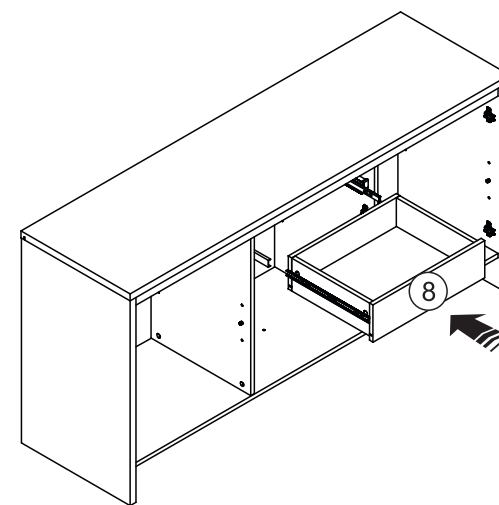

Como encaixar
as gavetas

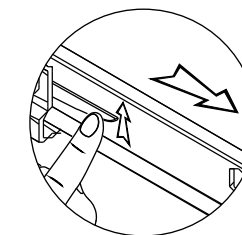

Como tirar
as gavetas

9

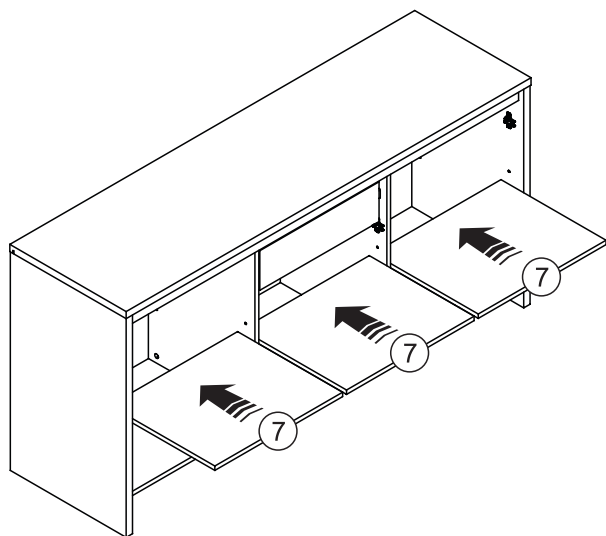

Ajuste das Portas

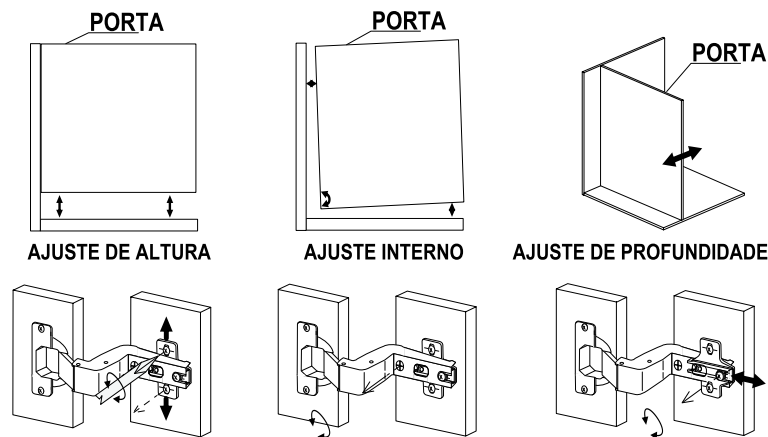

10

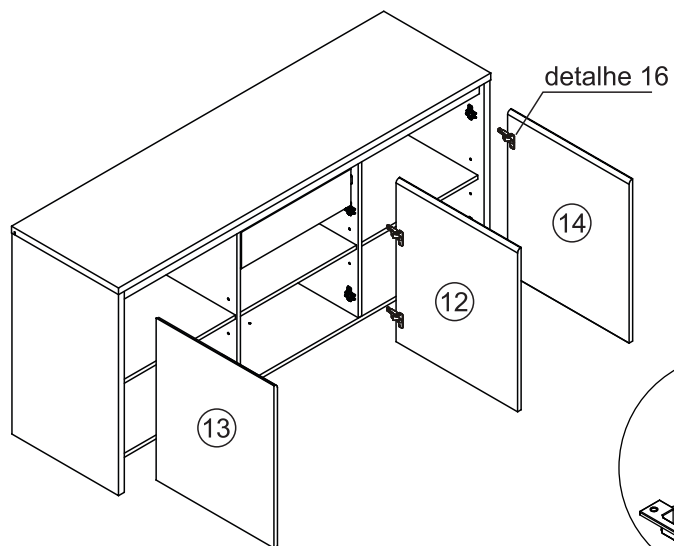

Capacidade de Carga (distribuídos uniformemente)

